



## CROSS PATTERN

## TOOLS REQUIRED

- Erasable pencil or masking tape
- Finishing nails, 18 gauge
- Finishing nailer
- Tape measure
- Level
- Mitre saw
- Carpenter's square
- Wood filler
- Caulking
- Caulking gun

## MATERIAL REQUIRED

## #1565 | SQUARE

- Thickness: 1-1/16"
- Width: 1-1/16"
- Length: 96"

## ADDITIONAL INFORMATION

- Exterior installation: No
- Type: Jointed pine
- When buying your material, allow about a 10% loss for cuts.

## RECOMMENDATIONS

It is strongly recommended that you take the measurements of your wall before beginning in order to adjust your plans and make the calculations necessary to complete your project. You can print this guide and make it your personalized plan, based on your space, so you can determine the quantity as well as the width of your geometric patterns.

## TIP

Use an erasable pencil/marker or masking tape to mark the location of the mouldings directly on your wall. If the dimensions of the geometric patterns do not provide the desired effect, adjust your plans. It is also recommended to paint the background of your wall in your desired colour before you begin to create the geometric patterns. Once the mouldings are installed, they can be painted to harmonize your project.



# INSTALLATION STEPS

## STEP 1: FRAME SPACE

- Ⓐ Place a moulding horizontally at the bottom of the wall or above your baseboard. Using a finishing nailer, fasten the moulding, making sure it is level. If the moulding does not cover the entire wall, measure the missing space and cut a second piece of moulding of this length to cover the span of the wall. Repeat at the top of the wall.
- Ⓑ Measure the entire length of the wall and divide it into the number of sections you want, to locate where the mouldings will be placed vertically. For example, for a space to be covered of 10 feet, there would be a moulding every 2 feet, i.e. 5 equal sections.
- Ⓒ Ideally, the pattern consists of a square. It is therefore recommended that your section width determined in step 1C becomes the space between your horizontal mouldings. For example, if your vertical mouldings are every 2 feet, it would be ideal to provide 3 sections of 2 feet, for a total height of 6 feet.

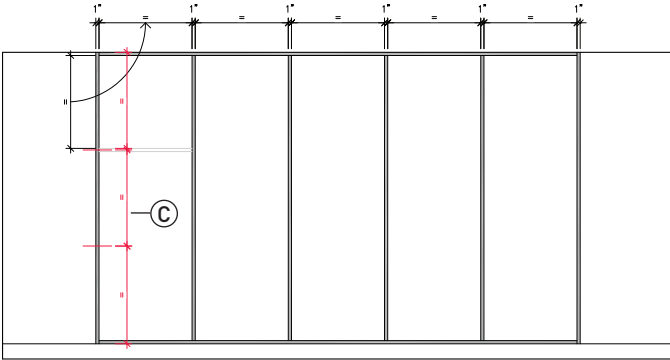

## STEP 2: SQUARES

- Ⓐ Measure the length between each vertical section, then cut the mouldings to fit snugly. Make sure you are square in all the squares created. Fasten the mouldings with a finishing nailer.

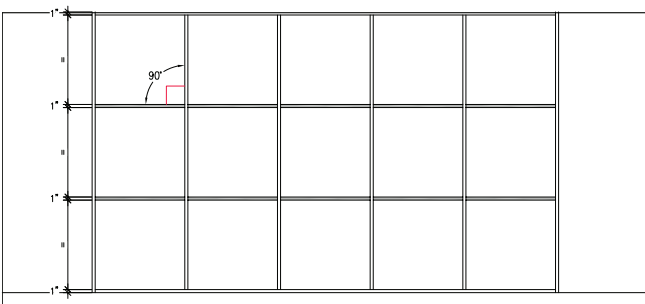

## STEP 3: "X" PATTERN DESIGN

- Ⓐ Measure the length of the first moulding that will be placed at an angle to separate the square into 2 identical triangles. Determine where the ends will need a 45 degree cut.
- Ⓑ Using a mitre saw, cut the ends of the moulding at a 45 degree angle, then fasten the moulding to the wall. It is recommended to use a carpenter's square.
- Ⓒ Measure and cut 2 small pieces of moulding that will attach in the centre of the square to both ends.

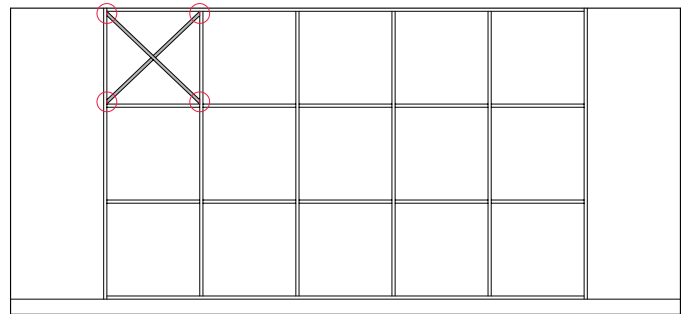

## STEP 4: IN THE OTHER SECTIONS

- Ⓐ Repeat Steps 3A to 3C.
- Ⓑ Use wood filler and caulking to conceal imperfections. Let dry, sand lightly and paint the mouldings the same colour as the background wall.

