



CHEVRON PATTERN

TOOLS REQUIRED

- Erasable pencil or masking tape
- Finishing nails, 18 gauge
- Finishing nailer
- Tape measure
- Level
- Mitre saw
- Carpenter's square
- Wood filler
- Caulking
- Caulking gun

MATERIAL REQUIRED

#1321 | RECTANGLE

- Thickness: 3/4"
- Width: 1-1/2"
- Length: 96"

ADDITIONAL INFORMATION

- Exterior installation: No
- Type: MDF with white primer
- When buying your material, allow about a 10% loss for cuts.

RECOMMENDATIONS

It is strongly recommended that you take the measurements of your wall before beginning in order to adjust your plans and make the calculations necessary to complete your project. You can print this guide and make it your personalized plan, based on your space, so you can determine the quantity as well as the width of your geometric patterns.

TIP

Use an erasable pencil/marker or masking tape to mark the location of the mouldings directly on your wall. If the dimensions of the geometric patterns do not provide the desired effect, adjust your plans. It is also recommended to paint the background of your wall in your desired colour before you begin to create the geometric patterns. Once the mouldings are installed, they can be painted to harmonize your project.



INSTALLATION STEPS

STEP 1: FRAME SPACE

Place a horizontal moulding (A) at the bottom of the wall or above your baseboard. Using a finishing nailer, fasten the moulding, making sure it is level. If the moulding does not cover the entire span of the wall, measure the missing space and cut a second piece of moulding to completely cover it. Repeat the same for the top of the wall.

Measure the length of the wall and divide it by the number of sections you want, to locate where the vertical mouldings (B) will be attached. For example, for a wall 15 feet long, you would have 3 equal sections, i.e. 4 vertical mouldings (B) every 5 feet from the left.

Measure the height between the two horizontal mouldings (A) to determine the length of the vertical mouldings (B) that you will have to cut. Fasten the vertical mouldings (B) with the finishing nailer. Make sure the mouldings are level.

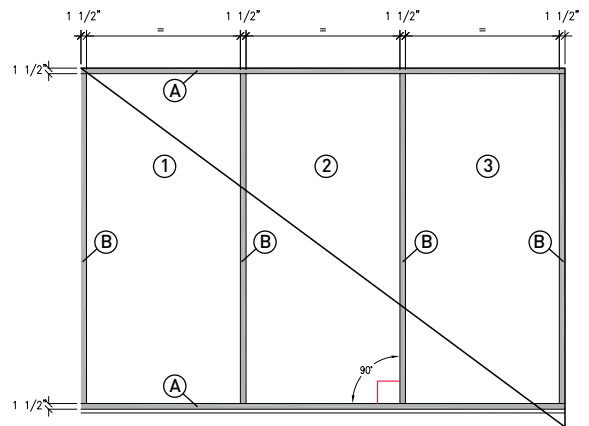

STEP 2: CENTER SECTION

Measure the length of the first moulding (C) of the centre section (2) that will be angled between the two vertical mouldings (B) and determine where the ends will require a 45-degree inside cut.

Using a mitre saw, cut the ends of the moulding at a 45 degree inside angle, then fasten the moulding. It is recommended to use a carpenter's square.

Choose the desired space between the different mouldings placed at an angle and make sure to leave equal space between each moulding.

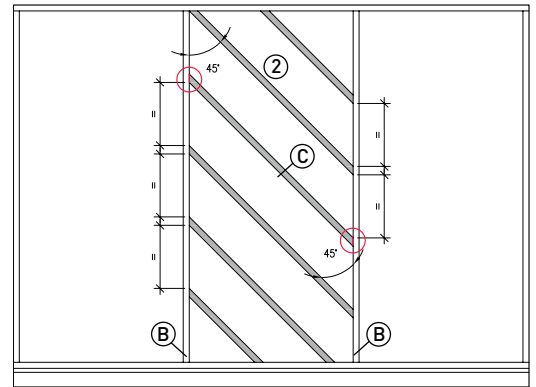

STEP 3: LEFT AND RIGHT SECTIONS

Measure the length of the mouldings (D) of the left section (1) between the two vertical mouldings (B) that will be placed inversely and aligned opposite each other, or sometimes between two mouldings (C) of the section (2).

Using a mitre saw, cut the ends of the mouldings (D) at a 45-degree inside angle, then fasten the moulding. It is recommended to use a carpenter's square.

Repeat the same steps for the right section (3), in order to reproduce the example shown.

Use wood filler and caulking to conceal imperfections. Let dry, lightly sand and paint the mouldings the same colour as the wall.

