



## PATTERN 1

### Tools required

- PL construction adhesive
- Caulking gun
- 18 gauge finishing nails
- Finish nailer
- Measuring tape
- Level
- Miter saw
- Saw bench

### WORKING ENVIRONMENT PREPARATION

Wall covering installation should be the last step of a construction or renovation project. First allow the product to acclimatize to the air and the ambient temperature for at least 72 hours prior to installation.

### SURFACE PREPARATION

Please note that the wall covering will not correct any apparent or pronounced defects on the wall. It is therefore essential to make sure the wall or surface you are covering is in good condition before beginning the installation. Even out the surface by eliminating any remaining glue, nails, or any other material that could interfere with the installation.

### INSTALLATION

Make sure the room is adequately lit. The first row of boards must be perfectly level. Figure out in advance if the installation will require finishing mouldings. If so, make sure to factor in the required space. We recommend measuring carefully to ensure the boards cut lengthwise line up perfectly with your starting line.

### BEFORE YOU BEGIN

Before installing the product, make sure that the wall complies with the conditions specified in this document. The installer and/or the buyer are responsible for inspecting the product before installing it. If the installer notices imperfections due to product manufacturing or finishing and cannot install the product in an inconspicuous location or eliminate the imperfections, they should not install it. If there are damaged components, put them aside and use them for cuts. A 5% imperfection rate is considered acceptable for each box. This percentage does not include the cutting loss mentioned above. Once the product is installed, it is considered to have been accepted as is by the installer and/or the buyer, even if they were not present during the installation. Customers must make sure the product purchased is suitable for the desired installation location.

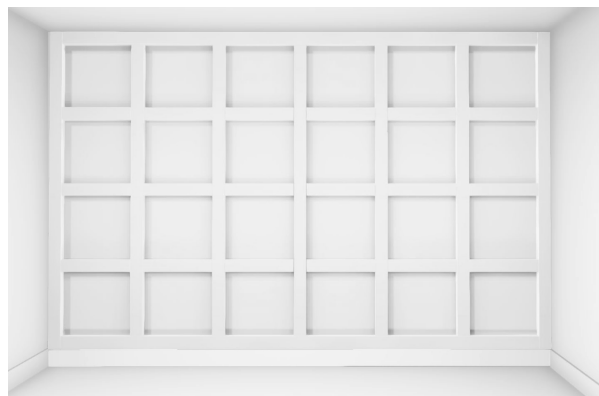

# WALL COVERING INSTALLATION STEPS

Note: In this example, the wall dimensions are 8' x 12' and the baseboard used is model 1263, which has a height of 4- 1/2" and the moulding used is model 0300, which has a width of 3-1/2".

## STEP 1:

Measure and cut the mouldings that will frame the wall. Using construction glue, install the mouldings making sure everything is level and square.

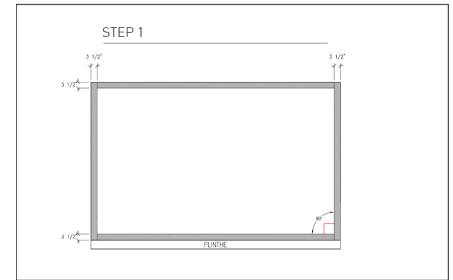

## STEP 2:

Draw your guidelines.

In order to determine the space between your boxes, you will need the following information:

- The total width of the wall
- The quantity of mouldings you want to use multiplied by the width of that moulding
- The number of panels desired in width

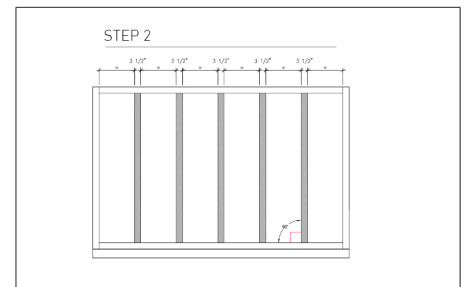

In this example, we have a 144" wall, seven 3.5" wide mouldings and 6 panels.

To calculate the space between the panels, the calculation will be as follows:  $(144 - (7 \times 3.5))/6 = 19.9"$ .

Measuring from the left, draw a line at 19.9" and then use construction glue to install a vertical moulding. Repeat this step until the 5 vertical mouldings are installed, creating 6 panels on the wall.

## STEP 3:

Repeat step 2 to determine the horizontal space between your panels.

You will need the following information:

- The height of the wall from the baseboard
- The number of mouldings you want to use multiplied by the width of that moulding
- The number of boxes desired in height

In this example, we have a 96" wall, five 3.5" wide mouldings and 4 panels to create.

To calculate the space between the boxes, the calculation will be as follows:  $(91.5 (5 \times 3.5))/4 = 18.5"$ .

Using a saw, cut your mouldings into 19.9" sections. Measuring from the ceiling, draw a line at 18.5".

Using construction glue, install a pre-cut horizontal moulding between each vertical moulding.

Repeat this step until the 18 pieces of moulding are installed.

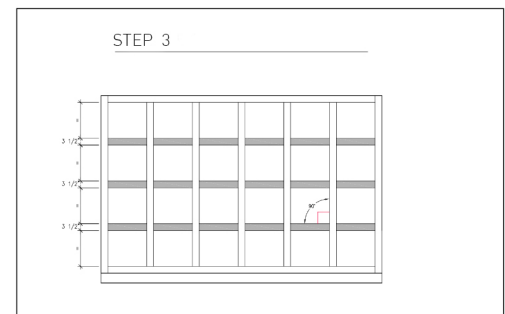

## STEP 4:

Nail the mouldings to the wall to keep them in place.

## STEP 5:

Caulk all the holes left by the nails, then sand. To keep everything uniform, do not forget to paint over the caulking if you have previously painted the mouldings.